



3 WAY FULL PORT STAINLESS STEEL BALL VALVE 1000 WOG THREADED ENDS T/L PORT ISO 5211 DIRECT ACTUATOR MOUNTING PAD

FIG.SBV-401DT/DL



Features:

- Actuator can be installed directly on the mounting pad without using bracket & coupling.
- Live-loaded packing gland design for self-adjustment of packing compression.
- Chevron V type packing to further ensure no leakage.
- Full port design to avoid pressure drop.
- Bottom-loaded blow-out proof stem. Low operating torque to reduce automation costs.
- Basic design complied with ANSI B16.34 & EN12516-1.
- NPT threaded ends complied with ANSI B 1.20.1.
- Rc, Rp & G Threaded ends complied with BS 21/2779, JIS B-0203/0202, DIN 259/2999 ISO 228-1, AS1722.1/1722.2 are upon request.
- Tested according to API 598.

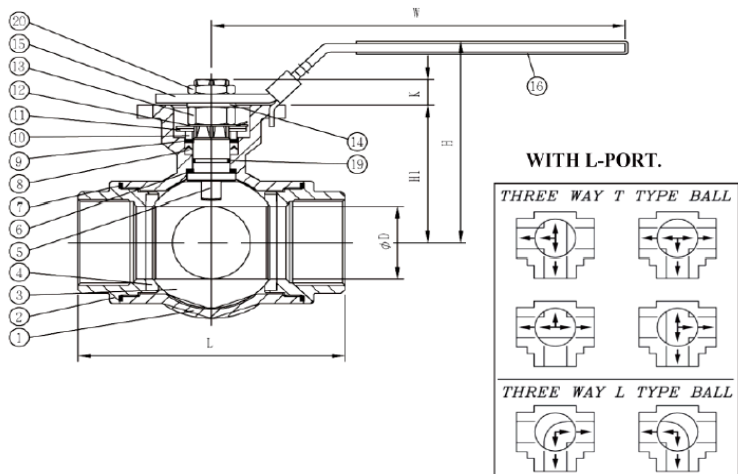
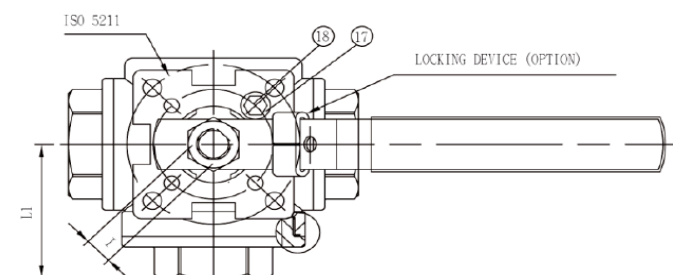

Materials List:

No.	Part Name	Specification
1	Body	ASTM A351-CF8M/316
2	End Cap	ASTM A351-CF8M/316
3	Ball	ASTM A351-CF8M/316
4	Seat	PTFE
5	Stem	ASTM A276-316
6	Thrust washer	PTFE
7	Gasket	PTFE
8	Stem Packing	PTFE
9	Packing Protector	TFM1600
10	Gland	AISI 304
11	Belleville Washer	AISI 304
12	Nut Lock	AISI 304
13	Packing Nut	AISI 304
14	Washer	AISI 304
15	Handle	AISI 304
16	Handle Cover	PVC
17	Handle Stopper	AISI 304
18	Stop Screw	AISI 304
19	O-ring	Viton
20	Handle Nut	AISI 304

OPTIONS:

- P: EQUIPPED WITH PNEUMATIC ACTUATOR
- L: LOCKING DEVICE.

Dimension:

Size	Ø D		L		I		L1		K		W		H		ISO 5211	H1		
	in	mm	in	mm	in	mm	in	mm	in	mm	in	mm	in	mm		in	mm	
¼	8	0.43	11	2.99	76.00	0.35	9	1.51	38.30	0.32	8.20	5.20	132	2.56	65.00	F03-F04	1.45	36.80
⅜	10	0.43	11	2.99	76.00	0.35	9	1.51	38.30	0.32	8.20	5.20	132	2.56	65.00	F03-F04	1.45	36.80
½	15	0.63	15	3.41	86.50	0.35	9	1.76	44.70	0.35	9.00	5.20	132	2.81	71.50	F03-F04	1.74	44.10
¾	20	0.79	20	4.06	103.00	0.43	11	2.00	50.80	0.45	11.50	7.09	180	3.70	94.00	F04-F05	2.17	55.10
1	25	0.98	25	4.65	118.00	0.43	11	2.27	57.70	0.45	11.50	7.09	180	3.94	100.00	F04-F05	2.39	60.70
1 ¼	32	1.26	32	4.96	126.00	0.55	14	2.46	62.60	0.59	15.10	8.86	225	4.57	116.00	F05-F07	2.96	75.20
1 ½	40	1.50	38	5.87	149.00	0.55	14	2.93	74.30	0.59	15.10	8.86	225	4.92	125.00	F05-F07	3.32	84.40
2	50	1.97	50	6.73	171.00	0.67	17	3.37	85.60	0.71	18.00	10.51	267	5.47	139.00	F07-F10	3.72	94.60

