



BELVEN

CAST IRON CHECK VALVE

FIG.CIGA-125F

CLASS 125 SWING CHECK VALVE FLANGED ENDS BOLTED COVER BRONZE TRIM



Features:

- Flange dimensions: ANSI B16.1
- Face-to-Face dimensions: ANSI B16.10
- Testing & Design: MSS-SP-71

Materials List:

No.	Part Name	Specification
1	Body	ASTM A126B
2	Seat ring	ASTM B62
3	Disc seal ring	ASTM B62
4	Disc	ASTM A126B
5	Hinge	ASTM A216 WCB
6	Washer	Carbon steel
7	Nut	Carbon steel
8	Stud	Carbon steel
9	Split pin	304SS
10	Hinge pin	13Cr
11	Plug	ASTM A536
12	Bolt	ASTM A307
13	Nut	Carbon steel
14	Cover gasket	Graphite & steel
15	Cover	ASTM A126B
16	Eye screw	Carbon steel
17	Adjusting screw	Carbon steel
18	Nut	Carbon steel

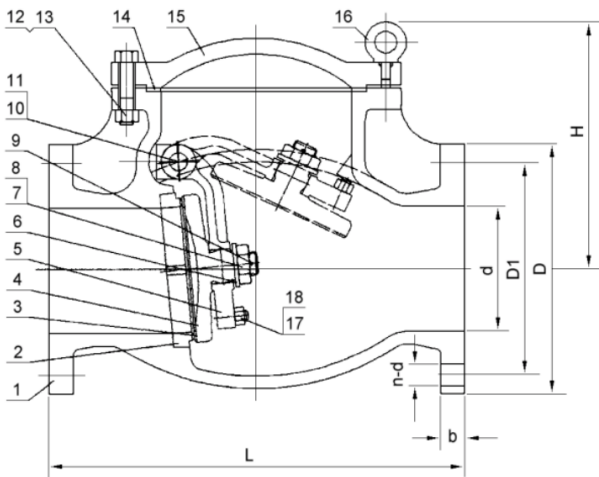

Dimensions:

Size		L		D		D1		b		n-d		H		Weight	
in	mm	in	mm	in	mm	in	mm	in	mm	in	in	mm	lb	kg	
2	50	8	203	6	152	4 ¾	121	⅝	15.9	4 - ¾	6	152	30	13.6	
2 ½	65	8 ½	216	7	178	5 ½	140	1 ⅛	17.5	4 - ¾	6 ⅝	162	50	22.7	
3	80	9 ½	241	7 ½	190	6	152	¾	19	4 - ¾	6 ⅝	175	55	25	
4	100	11 ½	292	9	229	7 ½	191	1 ⅛	23.8	8 - ¾	8 ⅝	219	86	39.1	
5	125	13	330	10	254	8 ½	216	1 ⅛	23.8	8 - 7/8	8 ⅝	225	130	59.1	
6	150	14	356	11	279	9 ½	241	1	25.4	8 - 7/8	10	254	154	70	
8	200	19 ½	495	13 ½	343	11 ¾	298	1 ⅛	28.6	8 - 7/8	11 ¾	298	279	127	
10	250	24 ½	622	16	406	14 ¼	362	1 ⅜	30.2	12 - 1	14 13/16	376	407	185	
12	300	27 ½	699	19	483	17	432	1 ¼	31.8	12 - 1	16 1/8	410	594	270	
14	350	31	787	21	533	18 ¾	476	1 ⅜	34.9	12 - 1 1/8	17 ½	445	829	377	
16	400	36	914	23 ½	597	21 ¼	540	1 7/16	36.5	12 - 1 1/8	19 ¾	502	1148	522	
18	450	36	914	25	635	22 ¾	578	1 9/16	39.7	16 - 1 ¼	27 ½	699	1727	785	
20	500	40	1016	27 ½	699	25	635	1 11/16	42.9	20 - 1 ¼	29 ¼	743	2596	1180	
24	600	48	1219	32	813	29 ½	749	1 7/8	47.6	20 - 1 3/8	33 ¼	845	3520	1600	