

ANSI Grooved Butterfly Valve

Fig.No.D81X700

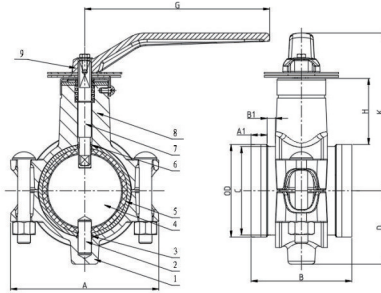

The grooved butterfly valve is simple, with compact and 90° slewing crane structure, it's mainly used for low pressure pipeline.

- Dimensions:2"(DN50)–6"(DN150)
- Design Standard:MSS SP–67
- Connection Standard:AWWA C606
- Working Pressure:200PSI,175PSI
- Application:The grooved butterfly valve is an important component of the oil and gas system.The operating temperature range is 0°C–80°C
- Material of Matching Products:Ductile iron Grooved Coupling,like MECH type 1N,1NS, 1G,1GS
- Material:ASTM A536,65–45–12
- Standard:AWWA C606

Part No.	Part	Standard Specification	Options
1	Lower Body	ASTM A536,65-45-12	
2	Stub Shaft	Stainless Steel	AISI 304、AISI 316、AISI 420、AISI 431
3	O-Ring	NBR	EPDM
4	Disc	AISI 316	DI, AISI 304, AL-Bronze C95400
5	Body	Carbon Steel+NBR	Carbon Steel+EPDM
6	O-Ring	NBR	EPDM
7	Drive Shaft	Stainless Steel	AISI 304、AISI 316、AISI 420、AISI 431
8	Upper Body	ASTM A536,65-45-12	
9	Hand Lever	ASTM A536,65-45-12	

Size		Dimension(mm)									
Inch	mm	A	B	D	OD	K	G	C	A1	B1	H
2"	50	105	81	47.5	60.3	119.6	139.7	57.15	15.88	7.93	55.3
3"	80	145	96.8	69.9	88.9	151.5	177.8	84.94	15.88	7.93	63.6
4"	100	180	115.8	88.9	114.3	179.9	228.6	110.08	15.88	9.53	70
6"	150	241.3	147.6	114.3	165.1	230	304.8	160.9	15.88	9.53	76.9
6"	150	241.3	147.6	114.3	168.3	230	304.8	163.96	15.88	9.53	76.9