

Swing Check Valve

Fig. No.H44X2

003073.7



H44X2

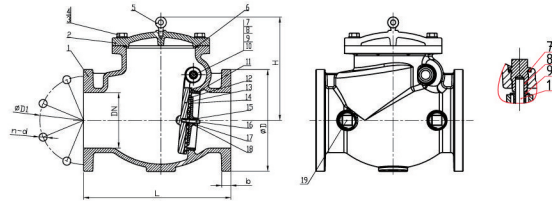

- Connection Ends: Flange to ASME B16.1 CL 125
- Working Pressure: 300PSI
200PSI and 250PSI available upon request
- Temperature Range: Rubber Seal: 0°C- 80°C,
Metal Seal: -10°C- 200°C
- Coating: Fusion Bonded Epoxy Coating in accordance with ANSI/AWWA C550 or painting upon request

MATERIAL SPECIFICATION

Part No.	Part	Standard Specification
1	Body	Ductile Iron 65-45-12
2	Bonnet	Ductile Iron 65-45-12
3	Bolts	Carbon Steel Zinc Plated
4	Washer	Carbon Steel Zinc Plated
5	Eye Bolt	Carbon Steel Zinc Plated
6	O-Ring	NBR
7	Washer	PTFE
8	Plug	AISI 304
9	Hinge Bushing	Brass ASTM B16 C36000
10	Hinge Pin	AISI 410
11	Seat Ring	Bronze ASTM B62
12	Seal	EPDM
13	Disc	Ductile Iron 65-45-12
14	Plate	SS410(2"- 4") Ductile Iron 65-45-12(6"-12")
15	Nut	AISI 304
16	Bolt	AISI 304
17	Spring Washer	AISI 304
18	Flat Washer	AISI 304
19	Plug	Tin bronze

Note: For special material request other than standard specification, please indicate clearly on the inquiry or order list.

DN		Dimensions(mm)						
Inch	mm	L		D	D1	b	n-Φd	H
		Standard	Optional					
2"	50	203	203	152	120.5	16	4-Φ 19.1	133
2.5"	65	254	216	178	139.5	17.5	4-Φ 19.1	150
3"	80	278	241	191	152.5	19	4-Φ 19.1	150
4"	100	330	292	229	190.5	24	8-Φ 19.1	218
6"	150	406	356	279	241.5	25.5	8-Φ 22.2	290
8"	200	495	495	343	298.5	28.5	8-Φ 22.2	330
10"	250	622	622	406	362	30.5	12-Φ 25.4	350
12"	300	660	698	483	432	32	12-Φ 25.4	376

Note: Standard of Face-to-Face in according with AWWA C508.
Optional of Face-to-Face in according with ASME B16.10 CL125.